

Model WMIC2B

Wireless Sound System

User's Guide



DUKANE iHear

14-00033 v00

Introduction

Thank you for buying this product.

- If you need service contact your dealer or call Dukane.
- Please read the User's Manual before using.
- Receiver Amp: Electronic equipment specification:

Input: DC19V  2A 

Rating: 110V - 240V

- MIC Tx: Electronic equipment specification:
Input: USB DC 5V to charge the transmitter.

DUKANE CORP AV SERVICE DEPT
2900 Dukane Drive
St Charles, IL 60174
800-676-2487
Fax 630-584-5156
avservice@dukane.com
www.dukane.com/av/service

Notice

FCC Radiation Exposure Statement

The equipment complies with FCC radiation exposure limits set forth for uncontrolled equipment and meets the FCC radio frequency (RF) Exposure Guidelines in Supplement C to OET65. The equipment has very low levels of RF energy that it is deemed to comply without testing of specific absorption ratio (SAR).

- 1.Changes or modifications are not expressly approved by the manufacturer could void the user's authority to operate the equipment. Changes or modifications to the device may void FCC and CE compliance. In frequently used radio links should be tested regularly to protect against undetected interference or fault.
- 2.Operation is subject to the following two conditions:
 - (1) this device may not cause interference, and
 - (2) this device must accept any interference, including interference that may cause undesired operation of the device.

Danger

3. Don't modify this product in any way. Such action could cause a fire, electric shock, serious personal injuries or product damage. Only a distributor or service center can provide maintenance and repair.
4. Please keep away from flammable or explosive gases when using this product.
5. If any liquid or object enters the product, stop use of the product. Please contact the distributor or a service center, and don't continue to use the product.
6. Operating this product with wet hands could cause electric shock.
7. Don't use this product while in an aircraft.

Warning

1. For safety reasons, please keep the product and accessories out of reach of small children or animals to avoid accidents such as:
 - swallowing the product or accessories. If this happens please see a doctor immediately.
 - Some small parts of product could cause personal injuries.
2. Do not place this product in a high temperature environment, high or low temperature environments may negatively effect the internal parts, or even result in fire.

Do not place in: microwave oven, radiator, or refrigerator, since this may cause the product battery to explode.

Caution

1. If a credit card is held near the speaker, it will be demagnetized. Please keep credit cards away from this product.
2. A malfunction of this product will occur if using a power adapter that doesn't match the one supplied with the product.
3. Painting this product is prohibited. Do not paint this product. Painting will affect it's normal use.
4. Do not hit or drop the product.

Packing List

Components



Speaker – Receiver

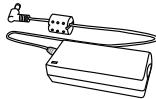

Switching adapter

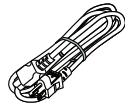

Power Cord



3.5mm Audio Cable

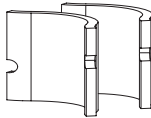

Foam



Quick Start Guide



Wireless Mic
Transmitter



USB Cable



Lanyard



Collar Clip Mic

Instruction

Speaker

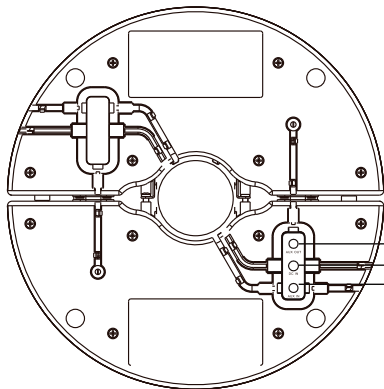

AUX OUT (to other module)
DC IN
AUX IN

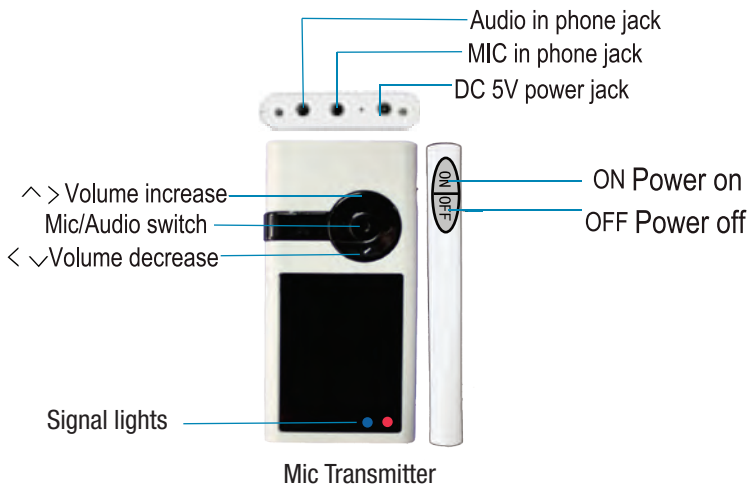

Caution

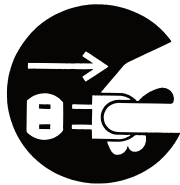
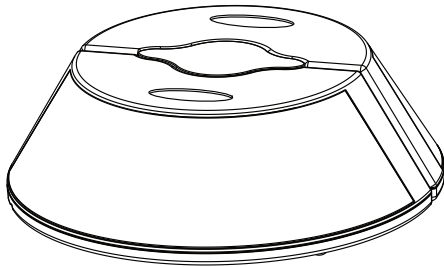

Special note: The center button on the mic transmitter switches the audio between the AUDIO IN port and the MIC IN port. This could be the reason that the Mic is not heard.

Speaker assembly

1

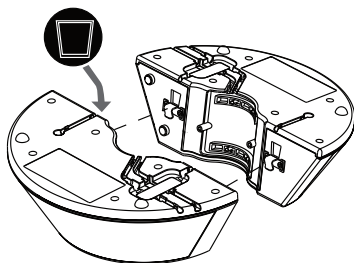

2

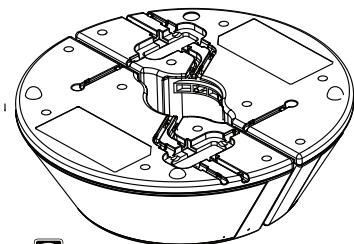

3

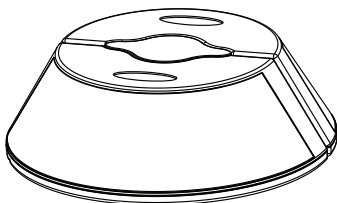

Installation

- 1** Put the foam pads on the inner side of speaker.

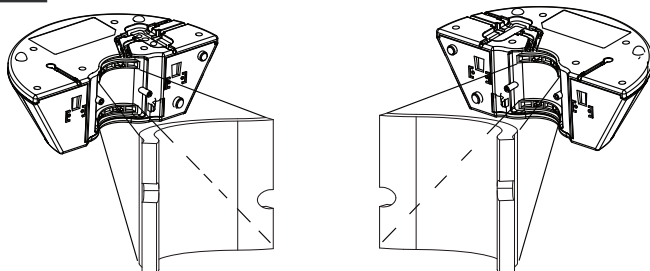

- 2** Connect main module and auxiliary module by metal hooks and locate on the pole.

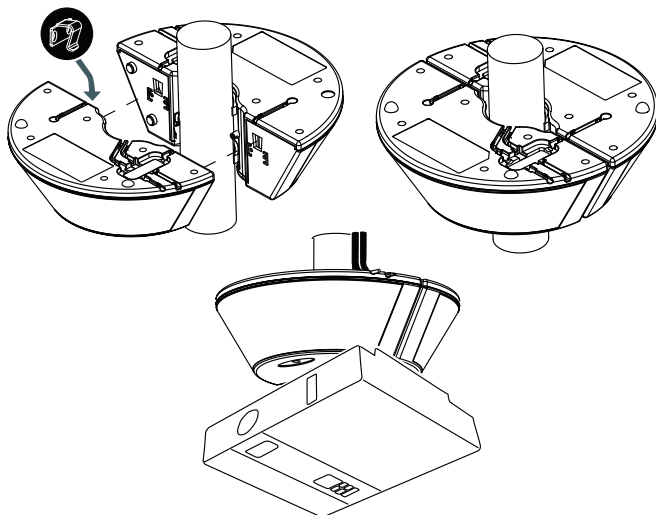

Audio Source Connection

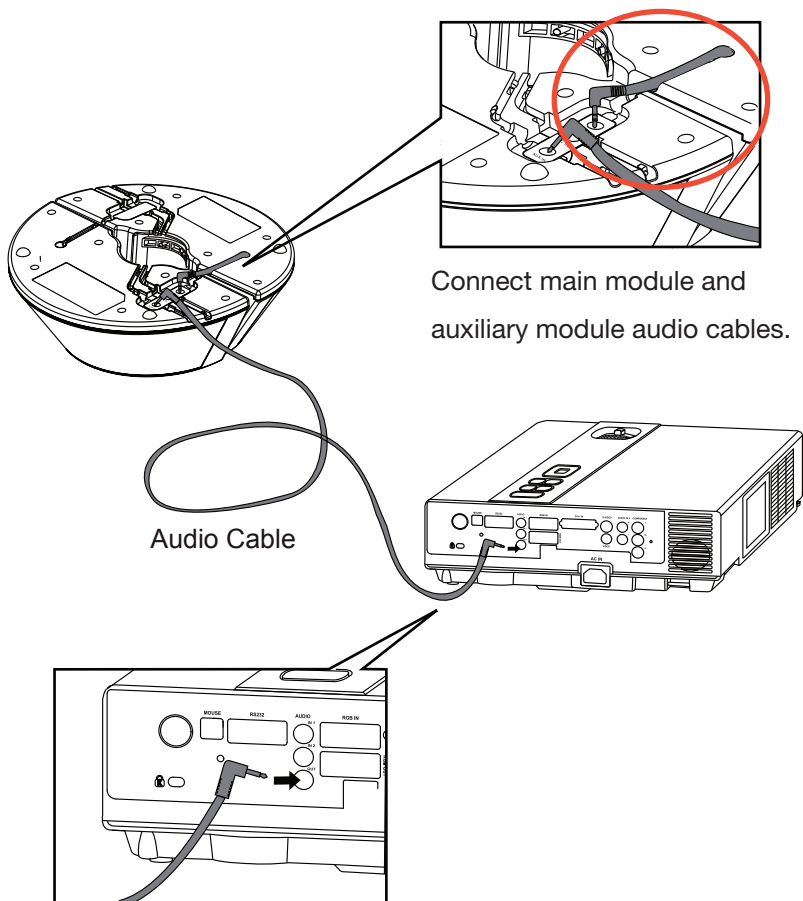

Connect main module and projector by audio cable.

Power Connection

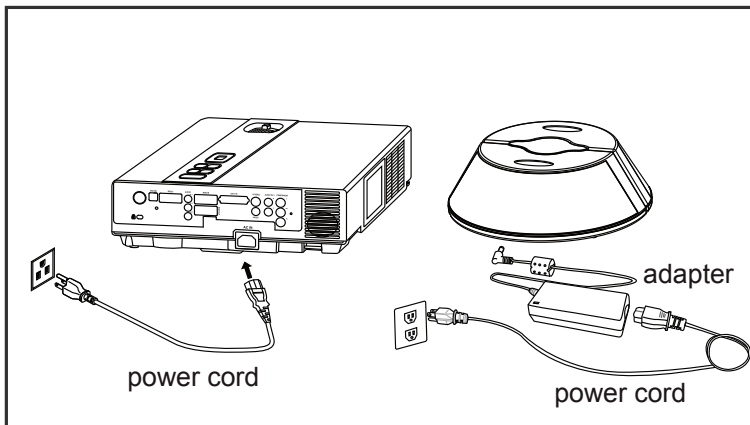

Charging the MIC TRANSMITTER Battery

The miniature MIC TRANSMITTER is charged using the cable with the USB connector and the small DC power connector pin which inserts into the top of the TRANSMITTER. The USB end is plugged into a powered USB port such as on a computer. A constant on red LED indicates the battery is charging.

Please be sure the USB port remains active. If the computer goes to sleep the port will go OFF and the port will discharge or drain the TRANSMITTER battery

Connecting Components

Wireless microphone connection :

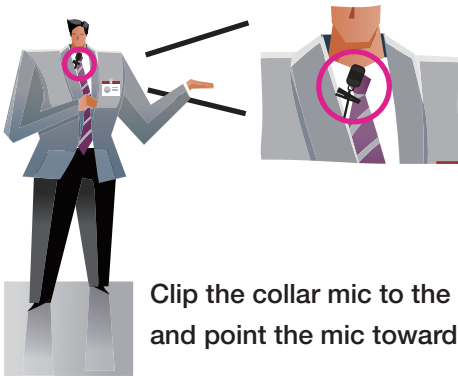
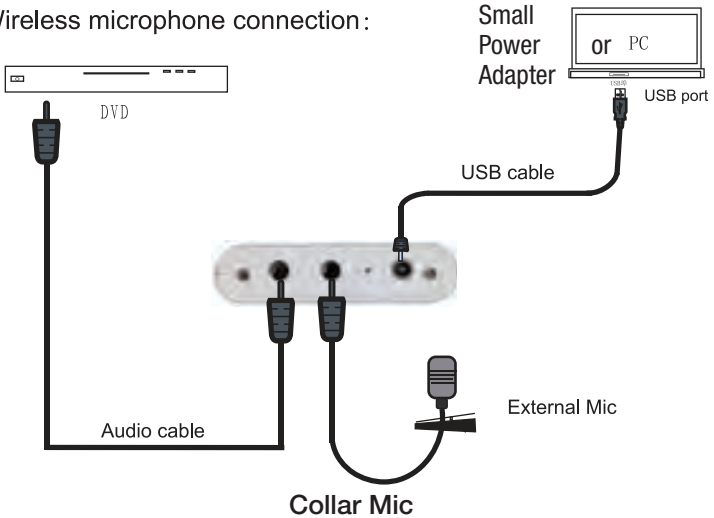

Clip the collar mic to the necktie or collar and point the mic toward the throat.

Light Signal Specification

Blue Light	Red Light	Light Instruction
OFF	OFF	Power off
Quick flashing		Matching state (seeking)
Slow flashing		Match successful in connecting state
Slow flashing		MIC mode if flash one time every 2.5s
Slow flashing		Audio mode if flash two times every 2.5s
	ON	Charging, red light turns off automatically after charging complete
	Slow flashing	Low power and need to charge if flash one time every 2.5s
	Quick flashing	NO signal connection between mic and speaker

Matching Procedure

1. Turn on the mic, frequency matching procedure needs 3 seconds.
2. After the mic Red/Blue LED's are alternately flashing a "Beep - Beep" sound will be heard. This means the mic and speaker-receiver are paired (matched).
3. Matching distance is under 10 feet between mic and speaker.
4. Make sure the bottom of mic transmitter is not blocked.
5. If the matching (pairing) of the system does not occur the MIC TRANSMITTER may need to be reset. Turn the MIC TRANSMITTER OFF. Then press and hold a button on the multifunction switch and turn ON the MIC TRANSMITTER. Release the button after the red LED comes ON.

Mode Setup – Settings for the AUX AUDIO INPUT on the Speaker

There are 4 modes of operation for the AUX AUDIO input on the top of the speaker unit. This Input is located next to the DC INPUT. The audio entering this port can be set to operate in one of 4 ways.

Mode 1. MIC Only: Only sound from the Miniature MIC TRANSMITTER is amplified. No AUDIO AUX (it is turned Off)

Mode 2. Mixed audio; The MIC TRANSMITTER and AUX AUDIO INPUT are mixed.

Mode 3. MIC priority operation; The MIC audio, when present, will have the priority and turn off the AUX AUDIO.

Mode4. AUX AUDIO INPUT priority; The Aux IN on the speaker unit will have priority over the Mic input .

Setting the mode. The MIC TRANSMITTER is used to set the mode. Start with it OFF.

Mode 1. Hold down the MIC TRANSMITTER key 1 (Volume up) button and turn ON the power.

Mode 2. Hold down the MIC TRANSMITTER key 2 (Right key) button and turn ON the power

Mode 3. Hold down the MIC TRANSMITTER key 3 (Volume down) button and turn ON the power.

Mode 4 Hold down the MIC TRANSMITTER key 4 (Left key) button and turn ON the power.

See the figure.

MIC TRANSMITTER



Speaker Top View connections

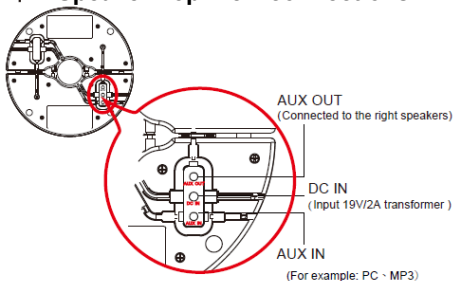

Troubleshooting

1. Q: The mic transmitter is ON but no sound is heard.
A:
 1. Please make sure the mic transmitter is within 10 feet of the speaker unit..
 2. Please make sure the mic transmitter has power. The LED signal lights flash.
 3. Please make sure the speaker has power.

2. Q: No signal light on the mic transmitter after it has been turned ON.
A: Please charge the mic transmitter.

3. Q: Low voice (sound) when using the mic transmitter.
A: Manually adjust the volume button to increase volume.

4. Q: The mic transmitter doesn't work when charging is attempted.
A: Please check to see if the power adapter is plugged in.

5. Q: The system can't complete matching process.
A:
 1. Please make sure the mic distance is within 10 feet of the speaker.
 2. Please make sure the power is ON.

6. Q: How long can the mic be used?
A: The complete charging process requires at least 4 hours of continuous charging. The mic can be used at least at least 8 hours. The mic transmitter red LED will begin to slowly flash (every 2 seconds) once there is less than 1 hour of operating time remaining.

Special note: The center button on the mic transmitter switches the audio between the AUDIO IN port and the MIC IN port. This could be the reason that the Mic is not heard.

DUKANE CORP AV SERVICE DEPT
2900 Dukane Drive
St Charles, IL 60174
800-676-2487
Fax 630-584-5156
avservice@dukane.com
www.dukane.com/av/service